

General Purpose Pressure Gauge: Stainless Steel Case

Model 414

Case and bezel material:	304 Stainless Steel
Connection:	Copper alloy
Bourdon tube material:	Copper alloy
Working temperature:	Ambient = -20~60° C, Process = +70° C
Dial:	Black print kPa, red print PSI, on white background
Ranges:	-100~0 kPa to dual scale 0~4000 kPa/PSI
Connection:	1/8" BSPT, (50 mm lower mount is 1/4" BSPT)
Window:	Polycarbonate
Surge protection:	Available on request
Movement:	Copper alloy
Pointer:	Aluminium black finish
Accuracy:	+/- 2.5% of full scale

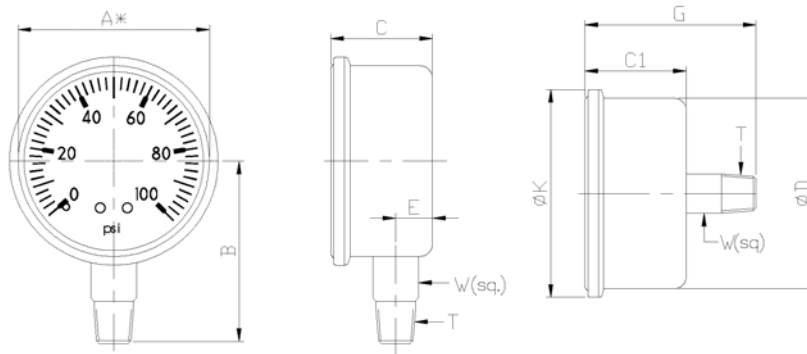

	A*	B	C	C1	D	E	G	K	T	W _{LM}	W _{CBM}
40	38.0	37.0	22.0	26.2	40.7	7.0	45.7	42.0	1/8" BSPT	11	14
50	50.3	45.3	27.8	28.0	51.5	10.0	45.2	57.6	1/8" BSPT	14	14

40 mm Diameter			50 mm Diameter		Accessories
Range (in kPa)	Lower Mount P/N	Centre Back Mount P/N	Lower Mount P/N	Centre Back Mount P/N	
-100-0		1610601	1610860	1612040	40mm panel mount kit Part No.: 1610850
-100/+150					
-100/+1000					50mm panel mount kit Part No.: 1612450
-100/+1500					
0-100			1610880		50mm front flange Part No.: 1612452
0-160			1610900		
0-250	1610350	1610620 ₁	1611080 ₅	1612050 _{7,8}	50mm front flange Part No.: 1612452
0-400	1610400	1610650 _{2,3}	1611150	1612163	
0-600					Restrictor 0.46mm Part No.: 1619915
0-800			1611263	1612245 ₉	
0-1000	1610520	1610750 ₄	1611302	1612300 ₁₀	Restrictor 0.25mm Part No.: 1619916
0-1600			1611350	1612400 ₁₁	
0-2500			1611390 ₆		Restrictor 0.25mm Part No.: 1619916
0-4000			1611700	1612470	
Weight gms	60	90	120	125	

Legend

- | | | | |
|---|---------------------|---|---------------------|
| 1. With 1/8" NPT & the word INSTRUMENT | - Part No.: 1610611 | 7. Available with 1/4" BSPT | - Part No.: 1612052 |
| 2. With 1/8" NPT & the word OUTPUT | - Part No.: 1610661 | 8. Available with 1/4" BSPT & Filter Clean Dial | - Part No.: 1612120 |
| 3. With 1/8" NPT & the word SUPPLY | - Part No.: 1610671 | 9. Available with 1/4" BSPT | - Part No.: 1612250 |
| 4. Available with 1/4" BSPT | - Part No.: 1610780 | 10. Available with 1/4" BSPT | - Part No.: 1612350 |
| 5. Available with Filter Clean Dial | - Part No.: 1611100 | 11. Available with 1/4" BSPT | - Part No.: 1612440 |
| 6. Supplied with 1/4" NPT | | | |