

# Liquid Filled General Purpose Pressure Gauge

## Model 411

<b>Case and bezel material:</b>	304 stainless steel, liquid filled with vent plug
<b>Connection:</b>	Copper alloy
<b>Bourdon tube material:</b>	Copper alloy
<b>Working temperature:</b>	Ambient = -20~60° C, Process = +70° C
<b>Dial:</b>	Black print (kPa) red print (PSI) on white background
<b>Ranges:</b>	-100~0 kPa to dual scale 0~40000 kPa/PSI
<b>Connection:</b>	¼" BSPT for 63 mm, 3/8" BSPT for 100 mm
<b>Surge Protection:</b>	Available on request
<b>Window:</b>	Polycarbonate
<b>Movement:</b>	Copper alloy
<b>Pointer:</b>	Aluminium black finish
<b>Accuracy:</b>	+/- 2.5% of full scale

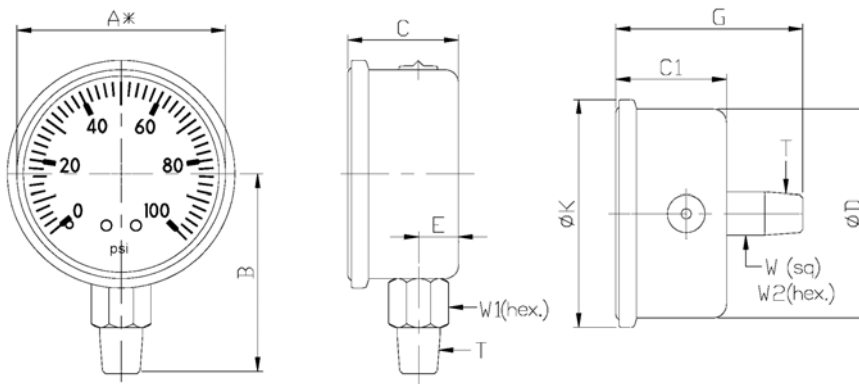

Dimensions in mm

	A*	B	C	C1	D	E	G	K	T	W1	W2
63	62.2	54.5	30.0	30.5	60.8	10.0	58.8	68.8	¼" BSPT	14.0	14.0
100	96.5	78.5	32.0	34.3	98.7	9.8	73.0	104.0	¾" BSPT	22.0	21.0

Range (in kPa)	63mm diameter		100mm diameter		Accessories
	Lower Mount P/N	Centre Back Mount P/N	Lower Mount P/N	Centre Back Mount P/N	
-100-0	1613850	1615050			63mm panel mount kit P/N: 1615950
-100/+150			1618525		
-100/+1000			1618527		
-100/+1500					63mm front flange P/N: 1615952
0-100	1613900	1615100			
0-250	1613950	1615150	1618530		Restrictor 0.46mm P/N: 1619915
0-400	1614000		1618540		
0-600	1614050	1615250			
0-800	1614100	1615300	1618560		Restrictor 0.25mm P/N: 1619916
0-1000	1614150	1615350	1618570		
0-1600	1614200	1615400 *	1618580	1618690 **	
0-2500	1614250	1615450	1618590		63mm rubber boot P/N: 1619919
0-4000	1614300	1615500	1618600		
0-6000	1614325	1615550			
0-8000	1614350	1615600			
0-10000	1614400				
0-16000	1614450	1615650			
0-25000	1614520	1615700	* = Available with U-Bracket P/N 1615402		
0-40000	1614580	1615930	** = Liquid fillable		
0-55000		1615945			
<b>Weight gms</b>	225	260	515	335	